

Hexagon nuts thin DIN 439 / ISO 4035

Item description/product images

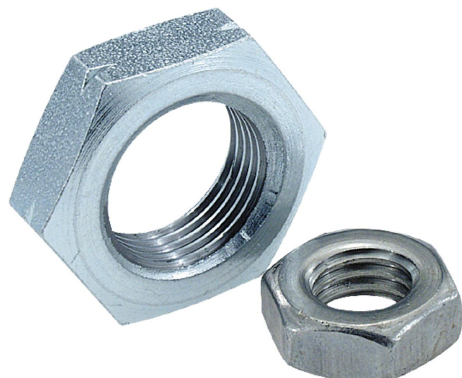

Description

Material:

Steel, stainless steel A2 or stainless steel A4.

Version:

Steel grade 04, electro zinc-plated or black oxidized.

Stainless steel A2, bright.

Stainless steel A4, bright.

Note:

These hexagon nuts are used in screw connections exposed to limited loads, e.g. as a locknut for clevis joints or rod ends.

The maximum nut height H max. is shown in the table.

Drawings

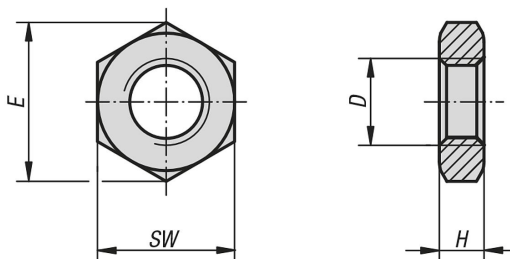

Hexagon nuts thin DIN 439 / ISO 4035

Order No.	Main material	Surface finish body	Version 2	D	E	H	SW	DIN	ISO
K0700.05	steel	galvanized	rh thread	M5	8,79	2,7	8	DIN 439	ISO 4035
K0700.06	steel	galvanized	rh thread	M6	11,05	3,2	10	DIN 439	ISO 4035
K0700.006	steel	galvanized	rh thread	M6X0,75	11,05	3,2	10	DIN 439	-
K0700.08	steel	galvanized	rh thread	M8	14,38	4	13	DIN 439	ISO 4035
K0700.008	steel	galvanized	rh thread	M8X1	14,38	4	13	DIN 439	-
K0700.10	steel	galvanized	rh thread	M10	18,9	5	17	DIN 439	-
K0700.103	steel	galvanized	rh thread	M10X1	18,9	5	17	DIN 439	-
K0700.104	steel	galvanized	rh thread	M10X1,25	18,9	5	17	DIN 439	-
K0700.12	steel	galvanized	rh thread	M12	21,1	6	19	DIN 439	-
K0700.123	steel	galvanized	rh thread	M12X1,25	21,1	6	19	DIN 439	-
K0700.124	steel	galvanized	rh thread	M12X1,5	21,1	6	19	DIN 439	-
K0700.14	steel	galvanized	rh thread	M14	24,49	7	22	DIN 439	-
K0700.16	steel	galvanized	rh thread	M16	26,76	8	24	DIN 439	ISO 4035
K0700.163	steel	galvanized	rh thread	M16x1,5	26,76	8	24	DIN 439	-
K0700.183	steel	galvanized	rh thread	M18x1,5	29,56	9	27	DIN 439	-
K0700.20	steel	galvanized	rh thread	M20	32,95	10	30	DIN 439	ISO 4035
K0700.203	steel	galvanized	rh thread	M20X1,5	32,95	10	30	DIN 439	-
K0700.223	steel	galvanized	rh thread	M22x1,5	36,9	10	32	DIN 439	-
K0700.24	steel	galvanized	rh thread	M24	39,55	12	36	DIN 439	ISO 4035
K0700.30	steel	galvanized	rh thread	M30	50,85	15	46	DIN 439	ISO 4035
K0700.061	steel	galvanized	lh thread	M6	11,05	3,2	10	DIN 439	ISO 4035
K0700.081	steel	galvanized	lh thread	M8	14,38	4	13	DIN 439	ISO 4035
K0700.101	steel	galvanized	lh thread	M10	18,9	5	17	DIN 439	-
K0700.1031	steel	galvanized	lh thread	M10X1	18,9	5	17	DIN 439	-
K0700.1041	steel	galvanized	lh thread	M10X1,25	18,9	5	17	DIN 439	-
K0700.121	steel	galvanized	lh thread	M12	21,1	6	19	DIN 439	-

Order No.	Main material	Surface finish body	Version 2	D	E	H	SW	DIN	ISO
K0700.1231	steel	galvanized	lh thread	M12X1,25	21,1	6	19	DIN 439	-
K0700.1241	steel	galvanized	lh thread	M12X1,5	21,1	6	19	DIN 439	-
K0700.161	steel	galvanized	lh thread	M16	26,76	8	24	DIN 439	ISO 4035
K0700.2031	steel	galvanized	lh thread	M20X1,5	32,95	10	30	DIN 439	-
K0700.2231	steel	galvanized	lh thread	M22x1,5	36,9	10	32	DIN 439	-
K0700.205	steel	black oxidized	rh thread	M5	8,79	2,7	8	DIN 439	ISO 4035
K0700.206	steel	black oxidized	rh thread	M6	11,05	3,2	10	DIN 439	ISO 4035
K0700.2063	steel	black oxidized	rh thread	M6X0,75	11,05	3,2	10	DIN 439	-
K0700.208	steel	black oxidized	rh thread	M8	14,38	4	13	DIN 439	ISO 4035
K0700.2083	steel	black oxidized	rh thread	M8X1	14,38	4	13	DIN 439	-
K0700.210	steel	black oxidized	rh thread	M10	18,9	5	17	DIN 439	-
K0700.2103	steel	black oxidized	rh thread	M10X1	18,9	5	17	DIN 439	-
K0700.212	steel	black oxidized	rh thread	M12	21,1	6	19	DIN 439	-
K0700.2124	steel	black oxidized	rh thread	M12X1,5	21,1	6	19	DIN 439	-
K0700.216	steel	black oxidized	rh thread	M16	26,76	8	24	DIN 439	ISO 4035
K0700.2163	steel	black oxidized	rh thread	M16x1,5	26,76	8	24	DIN 439	-
K0700.2203	steel	black oxidized	rh thread	M20X1,5	32,95	10	30	DIN 439	-
K0700.2243	steel	black oxidized	rh thread	M24x2	39,6	12	36	DIN 439	-
K0700.105	stainless steel A2	bright	rh thread	M5	8,79	2,7	8	DIN 439	ISO 4035
K0700.106	stainless steel A2	bright	rh thread	M6	11,05	3,2	10	DIN 439	ISO 4035
K0700.1062	stainless steel A2	bright	rh thread	M6X0,75	11,05	3,2	10	DIN 439	-
K0700.108	stainless steel A2	bright	rh thread	M8	14,38	4	13	DIN 439	ISO 4035
K0700.1083	stainless steel A2	bright	rh thread	M8X1	14,38	4	13	DIN 439	-
K0700.110	stainless steel A2	bright	rh thread	M10	18,9	5	17	DIN 439	-
K0700.1103	stainless steel A2	bright	rh thread	M10X1	18,9	5	17	DIN 439	-
K0700.1104	stainless steel A2	bright	rh thread	M10X1,25	18,9	5	17	DIN 439	-
K0700.112	stainless steel A2	bright	rh thread	M12	21,1	6	19	DIN 439	-
K0700.1123	stainless steel A2	bright	rh thread	M12X1,25	21,1	6	19	DIN 439	-
K0700.1124	stainless steel A2	bright	rh thread	M12X1,5	21,1	6	19	DIN 439	-
K0700.114	stainless steel A2	bright	rh thread	M14	24,49	7	22	DIN 439	-
K0700.116	stainless steel A2	bright	rh thread	M16	26,76	8	24	DIN 439	ISO 4035
K0700.1163	stainless steel A2	bright	rh thread	M16x1,5	26,76	8	24	DIN 439	-
K0700.120	stainless steel A2	bright	rh thread	M20	32,95	10	30	DIN 439	ISO 4035
K0700.1203	stainless steel A2	bright	rh thread	M20X1,5	32,95	10	30	DIN 439	-
K0700.1223	stainless steel A2	bright	rh thread	M22x1,5	36,9	10	32	DIN 439	-
K0700.1244	stainless steel A2	bright	rh thread	M24	39,55	12	36	DIN 439	ISO 4035
K0700.1243	stainless steel A2	bright	rh thread	M24x2	39,6	12	36	DIN 439	-
K0700.1061	stainless steel A2	bright	lh thread	M6	11,05	3,2	10	DIN 439	ISO 4035
K0700.1081	stainless steel A2	bright	lh thread	M8	14,38	4	13	DIN 439	ISO 4035
K0700.1101	stainless steel A2	bright	lh thread	M10	18,9	5	17	DIN 439	-
K0700.11031	stainless steel A2	bright	lh thread	M10X1	18,9	5	17	DIN 439	-
K0700.11041	stainless steel A2	bright	lh thread	M10X1,25	18,9	5	17	DIN 439	-
K0700.1121	stainless steel A2	bright	lh thread	M12	21,1	6	19	DIN 439	-
K0700.11231	stainless steel A2	bright	lh thread	M12X1,25	21,1	6	19	DIN 439	-
K0700.11241	stainless steel A2	bright	lh thread	M12X1,5	21,1	6	19	DIN 439	-
K0700.1161	stainless steel A2	bright	lh thread	M16	26,76	8	24	DIN 439	ISO 4035
K0700.12031	stainless steel A2	bright	lh thread	M20X1,5	32,95	10	30	DIN 439	-
K0700.12231	stainless steel A2	bright	lh thread	M22x1,5	36,9	10	32	DIN 439	-
K0700.605	stainless steel A4	bright	rh thread	M5	8,79	2,7	8	DIN 439	ISO 4035
K0700.606	stainless steel A4	bright	rh thread	M6	11,05	3,2	10	DIN 439	ISO 4035
K0700.6062	stainless steel A4	bright	rh thread	M6X0,75	11,05	3,2	10	DIN 439	-
K0700.608	stainless steel A4	bright	rh thread	M8	14,38	4	13	DIN 439	ISO 4035
K0700.6083	stainless steel A4	bright	rh thread	M8X1	14,38	4	13	DIN 439	-
K0700.610	stainless steel A4	bright	rh thread	M10	18,9	5	17	DIN 439	-
K0700.6103	stainless steel A4	bright	rh thread	M10X1	18,9	5	17	DIN 439	-
K0700.6104	stainless steel A4	bright	rh thread	M10X1,25	18,9	5	17	DIN 439	-
K0700.612	stainless steel A4	bright	rh thread	M12	21,1	6	19	DIN 439	-
K0700.6123	stainless steel A4	bright	rh thread	M12X1,25	21,1	6	19	DIN 439	-
K0700.6124	stainless steel A4	bright	rh thread	M12X1,5	21,1	6	19	DIN 439	-
K0700.614	stainless steel A4	bright	rh thread	M14	24,49	7	22	DIN 439	-
K0700.616	stainless steel A4	bright	rh thread	M16	26,76	8	24	DIN 439	ISO 4035
K0700.6163	stainless steel A4	bright	rh thread	M16x1,5	26,76	8	24	DIN 439	-
K0700.620	stainless steel A4	bright	rh thread	M20	32,95	10	30	DIN 439	ISO 4035

Hexagon nuts thin DIN 439 / ISO 4035

Order No.	Main material	Surface finish body	Version 2	D	E	H	SW	DIN	ISO
K0700.6203	stainless steel A4	bright	rh thread	M20x1,5	32,95	10	30	DIN 439	-
K0700.6223	stainless steel A4	bright	rh thread	M22x1,5	36,9	10	32	DIN 439	-
K0700.6244	stainless steel A4	bright	rh thread	M24	39,55	12	36	DIN 439	ISO 4035
K0700.6243	stainless steel A4	bright	rh thread	M24x2	39,6	12	36	DIN 439	-