

## Écrous croisillon en fonte grise, DIN 6335, forme L

Description de l'article/illustrations du produit

METRIC  
Parts



### Description

#### Matière :

Fonte grise GJL 200.

Vis sans tête en inox 1.4305 (correspond à AISI 303).

Goupille en inox 1.4310 (correspond à AISI 301).

#### Finition :

Écrou croisillon : poli.

Vis sans tête et goupille : naturel.

### Dessins

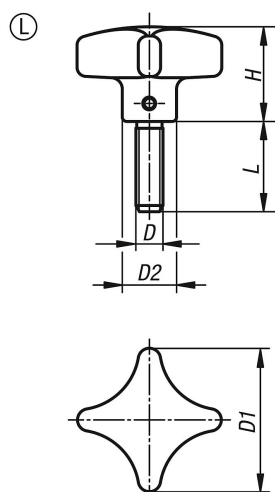

### Aperçu des articles

| Référence    | Forme | Finition 1 | D   | D1 | D2 | H  | L  |
|--------------|-------|------------|-----|----|----|----|----|
| K0147.606X15 | L     | -          | M6  | 32 | 12 | 20 | 15 |
| K0147.606X20 | L     | -          | M6  | 32 | 12 | 20 | 20 |
| K0147.606X25 | L     | -          | M6  | 32 | 12 | 20 | 25 |
| K0147.606X30 | L     | -          | M6  | 32 | 12 | 20 | 30 |
| K0147.606X40 | L     | -          | M6  | 32 | 12 | 20 | 40 |
| K0147.606X50 | L     | -          | M6  | 32 | 12 | 20 | 50 |
| K0147.608X20 | L     | -          | M8  | 40 | 14 | 25 | 20 |
| K0147.608X25 | L     | -          | M8  | 40 | 14 | 25 | 25 |
| K0147.608X30 | L     | -          | M8  | 40 | 14 | 25 | 30 |
| K0147.608X40 | L     | -          | M8  | 40 | 14 | 25 | 40 |
| K0147.608X50 | L     | -          | M8  | 40 | 14 | 25 | 50 |
| K0147.610X20 | L     | -          | M10 | 50 | 18 | 32 | 20 |
| K0147.610X25 | L     | -          | M10 | 50 | 18 | 32 | 25 |
| K0147.610X30 | L     | -          | M10 | 50 | 18 | 32 | 30 |
| K0147.610X40 | L     | -          | M10 | 50 | 18 | 32 | 40 |

**Écrous croisillon en fonte grise, DIN 6335, forme L****Aperçu des articles**

| Référence    | Forme | Finition 1 | D   | D1 | D2 | H  | L  |
|--------------|-------|------------|-----|----|----|----|----|
| K0147.610X50 | L     | -          | M10 | 50 | 18 | 32 | 50 |
| K0147.612X20 | L     | -          | M12 | 63 | 20 | 40 | 20 |
| K0147.612X30 | L     | -          | M12 | 63 | 20 | 40 | 30 |
| K0147.612X40 | L     | -          | M12 | 63 | 20 | 40 | 40 |
| K0147.612X50 | L     | -          | M12 | 63 | 20 | 40 | 50 |