

Poignées en plastique, rondes avec support rectangulaire

Description de l'article/illustrations du produit



Description

Matière :
Plastique.

Finition :
rouges, résistantes à l'huile.

Sur demande :
D'autres coloris.

Dessins

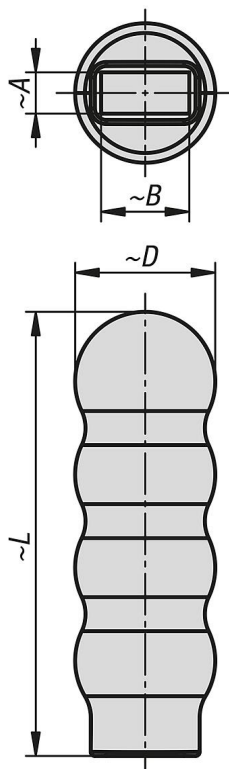

Aperçu des articles

Poignées en plastique, rondes avec support rectangulaire

Référence	A	B	D	L	pour sauterelle à levier
K2110.034141	4	8	14	34	K1259.01000, K1255.010001, K1255.101000, K1255.001000, K1438.00800, K1436.00800, K1239.01000, K1434.00700
K2110.040154	5	9	15	40	K1547.01000, K1547.11000
K2110.043161	5	11	16	43	K1244.00800, K1255.101800, K1255.001800, K1254.1800, K1254.0800, K1432.02000, K1432.12000
K2110.057171	4	10	17	57	K1259.02000, K1255.101600, K1255.001600, K1246.01600, K1436.01600
K2110.059191	5	11	19	59	K1241.12500, K1241.02500, K1251.02400, K1248.02400, K1246.02400, K1255.102400, K1255.002400, K1239.02500, K1434.01400, K1546.02400,

Poignées en plastique, rondes avec support rectangulaire

Aperçu des articles

Référence	A	B	D	L	pour sauterelle à levier
K2110.081241	6	14	24,5	81	K1241.03400, K1255.102600, K1255.002600, K1258.02600, K1433.03400, K1239.03400, K1435.01400, K1546.04000
K2110.083241	6	16	24,5	83	K1259.03600, K1255.003600, K1251.04000, K1258.04000, K1246.04000, K1255.104000, K1255.004000, K1437.03600, K1436.03000, K1440.03500,
K2110.086271	8	17	27	86	K1241.05000, K1255.040001, K1244.03400, K1258.04400, K1438.03400, K1433.05400, K1239.05400, K1435.02400
K2110.092271	9	17,5	27	92	K1241.06000, K1258.07000, K1248.07000, K1255.007000, K1244.04400, K1438.04400, K1239.06400, K1435.03000, K1440.07500, K1432.07000,
K2110.118341	9	24	34	118	K1258.08000, K1248.08000, K1255.008000, K1244.05400, K1438.05400

Référence	pour sauterelle à levier
K2110.034141	K1259.01000, K1255.010001, K1255.101000, K1255.001000, K1438.00800, K1436.00800, K1239.01000, K1434.00700
K2110.040151	K1547.01000, K1547.11000
K2110.043161	K1244.00800, K1255.101800, K1255.001800, K1254.1800, K1254.0800, K1432.02000, K1432.12000
K2110.057171	K1259.02000, K1255.101600, K1255.001600, K1246.01600, K1436.01600
K2110.059191	K1241.12500, K1241.02500, K1251.02400, K1248.02400, K1246.02400, K1255.102400, K1255.002400, K1239.02500, K1434.01400, K1546.02400,
K2110.081241	K1241.03400, K1255.102600, K1255.002600, K1258.02600, K1433.03400, K1239.03400, K1435.01400, K1546.04000
K2110.083241	K1259.03600, K1255.003600, K1251.04000, K1258.04000, K1246.04000, K1255.104000, K1255.004000, K1437.03600, K1436.03000, K1440.03500,
K2110.086271	K1241.05000, K1255.040001, K1244.03400, K1258.04400, K1438.03400, K1433.05400, K1239.05400, K1435.02400
K2110.092271	K1241.06000, K1258.07000, K1248.07000, K1255.007000, K1244.04400, K1438.04400, K1239.06400, K1435.03000, K1440.07500, K1432.07000,
K2110.118341	K1258.08000, K1248.08000, K1255.008000, K1244.05400, K1438.05400