

Adjustable handles, plastic, antibacterial with external thread, threaded insert stainless steel

Item description/product images



lift to
disengage



Description

Material:

Handles slate gray reinforced plastic, toothed ring die-cast zinc.
Steel parts stainless steel 1.4305 (AISI 303 equivalent).

Version:

Stainless steel bright.

Benefits:

Resistant to humidity and cleaning products (during disinfection) with no toxic side effects.

Applications:

For installation on machines, equipment, plants and furnishings in areas with increased hygienic requirements (including hospitals, doctors' surgeries, rehabilitation centers and food production facilities), as well as for use in public areas or regularly frequented institutions (i.e. nursing homes or daycare centers).

Adjustable handles, plastic, antibacterial with external thread, threaded insert stainless steel

Drawings

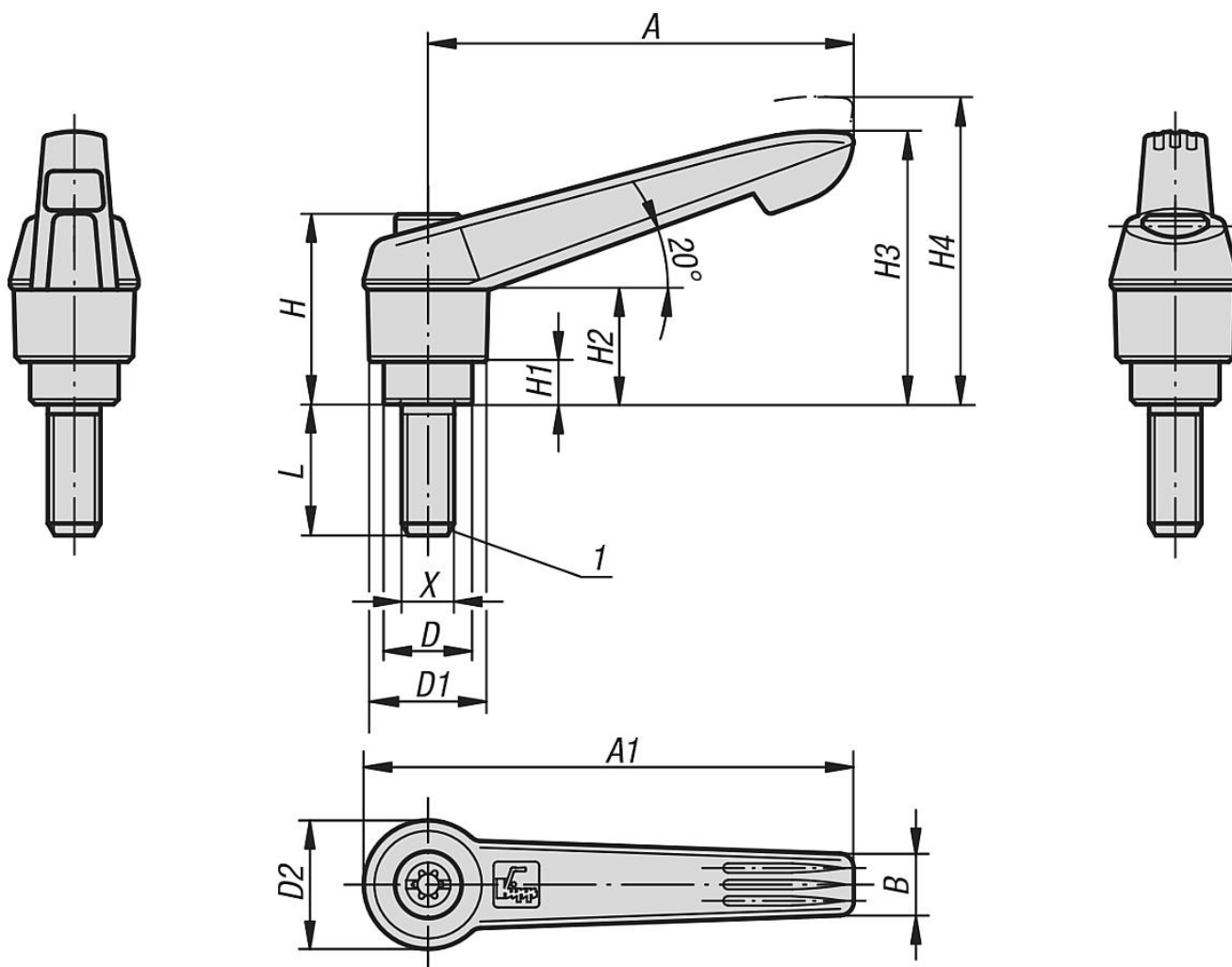

Adjustable handles antibacterial, external thread, plastic grip, metal parts stainless steel

Order No.	X	D	D1	D2	H	H1	H2	H3	H4	A	A1	B	No. of teeth	L
K0270.12206144X20	M6	13,5	18	19,5	28,5	6,5	17,5	41,5	45,5	65	75	9,5	20	20
K0270.12208144X20	M8	13,5	18	19,5	28,5	6,5	17,5	41,5	45,5	65	75	9,5	20	20
K0270.12210144X20	M10	13,5	18	19,5	28,5	6,5	17,5	41,5	45,5	65	75	9,5	20	20