

Spring hinges aluminum profile, 0.7 Nm, spring closed

Item description/product images



Description

Material:
aluminum 6060 T5.
End caps PA 6.6.
Washers POM.

Version:
Black anodized.
Colorless anodized.

Note:
These hinges have steel tension springs which enables doors and hatches to open or close automatically.
Opening angle 180°.

Spring torque:
M(0°): 0.7 Nm / M(90°): 0.45 Nm / M(180°): 0.23 Nm

These hinges have a more than 30,000 cycle service life.

Fastened using DIN 912/EN ISO 4762 socket head screws.

Temperature range:
From -20°C to +80°C

Accessory:
Socket head screws with hexagon socket DIN 912/EN ISO 4762.

Drawings

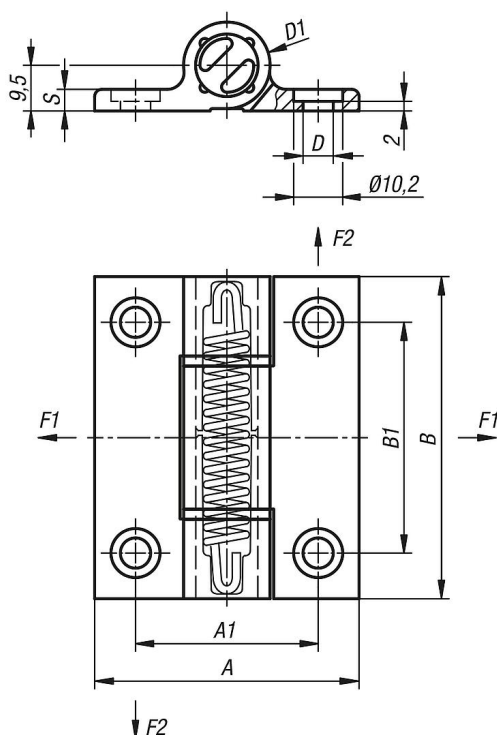

Hinges with closing spring

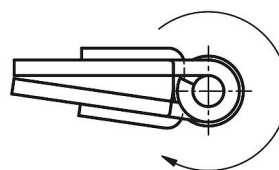

Spring hinges aluminum profile, 0.7 Nm, spring closed

Order No.	Main color	Surface finish body	A	A1	B	B1	D	D1	S	F1 N	F2 N
K1180.556711	black	anodized	55	38	67	48	6,3	18	4,5	5000	4200
K1180.55671	colorless	anodized	55	38	67	48	6,3	18	4,5	5000	4200