

Gear Levers, Style B, inch

Item description/product images



Description

Material:

Knobs thermoset PF 31.

Rod steel 1.0718 or stainless steel 1.4305 (AISI 303 equivalent).

Version:

Thermoset black, high-gloss polished.

Steel black oxidized or bright stainless steel.

Drawings

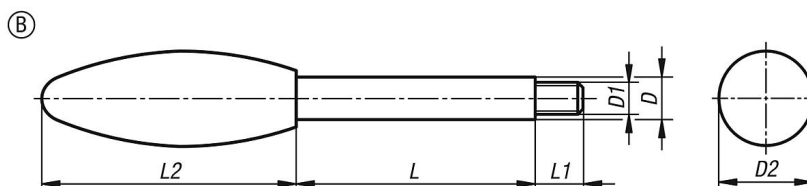

Order No.	Main material	style	D	D1	D2	L	L1	L2
K0179.7A2X35	steel	B	8	1/4-20	23	35	9	60
K0179.7A2X50	steel	B	8	1/4-20	23	50	9	60
K0179.7A2X65	steel	B	8	1/4-20	23	65	9	60
K0179.7A3X50	steel	B	10	5/16-18	26	50	13	70
K0179.7A3X65	steel	B	10	5/16-18	26	65	13	70
K0179.7A3X80	steel	B	10	5/16-18	26	80	13	70
K0179.7A3X100	steel	B	10	5/16-18	26	100	13	70
K0179.7A4X65	steel	B	12	3/8-16	35	65	15	85
K0179.7A4X80	steel	B	12	3/8-16	35	80	15	85
K0179.7A4X100	steel	B	12	3/8-16	35	100	15	85
K0179.7A4X125	steel	B	12	3/8-16	35	125	15	85
K0179.7A5X80	steel	B	14	1/2-13	35	80	16	85
K0179.7A5X100	steel	B	14	1/2-13	35	100	16	85
K0179.7A5X125	steel	B	14	1/2-13	35	125	16	85
K0179.7A5X160	steel	B	14	1/2-13	35	160	16	85
K0179.17A2X35	stainless steel	B	8	1/4-20	23	35	9	60
K0179.17A2X50	stainless steel	B	8	1/4-20	23	50	9	60
K0179.17A2X65	stainless steel	B	8	1/4-20	23	65	9	60
K0179.17A3X50	stainless steel	B	10	5/16-18	26	50	13	70
K0179.17A3X65	stainless steel	B	10	5/16-18	26	65	13	70
K0179.17A3X80	stainless steel	B	10	5/16-18	26	80	13	70
K0179.17A3X100	stainless steel	B	10	5/16-18	26	100	13	70
K0179.17A4X65	stainless steel	B	12	3/8-16	35	65	15	85
K0179.17A4X80	stainless steel	B	12	3/8-16	35	80	15	85
K0179.17A4X100	stainless steel	B	12	3/8-16	35	100	15	85
K0179.17A4X125	stainless steel	B	12	3/8-16	35	125	15	85
K0179.17A5X80	stainless steel	B	14	1/2-13	35	80	16	85
K0179.17A5X100	stainless steel	B	14	1/2-13	35	100	16	85
K0179.17A5X125	stainless steel	B	14	1/2-13	35	125	16	85
K0179.17A5X160	stainless steel	B	14	1/2-13	35	160	16	85

