

## Star grips, DIN 6336, gray cast iron, Style L, metric

Item description/product images

METRIC  
Parts



### Description

**Material:**

gray cast iron GJL 200.

Grub screw stainless steel 1.4305 (AISI 303 equivalent).

Pin stainless steel 1.4310 (AISI 301 equivalent).

**Version:**

Star grip vibratory ground.

Grub screw and pin bright.

### Drawings

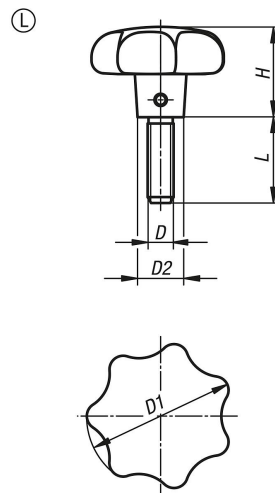

Order No.	style	Surface finish body	D	D1	D2	H	L
K0151.606X15	L	tumbled	M6	32	12	20	15
K0151.606X20	L	tumbled	M6	32	12	20	20
K0151.606X25	L	tumbled	M6	32	12	20	25
K0151.606X30	L	tumbled	M6	32	12	20	30
K0151.608X20	L	tumbled	M8	40	14	25	20
K0151.608X25	L	tumbled	M8	40	14	25	25
K0151.608X30	L	tumbled	M8	40	14	25	30
K0151.608X40	L	tumbled	M8	40	14	25	40
K0151.610X25	L	tumbled	M10	50	18	32	25
K0151.610X30	L	tumbled	M10	50	18	32	30
K0151.610X40	L	tumbled	M10	50	18	32	40
K0151.610X50	L	tumbled	M10	50	18	32	50
K0151.612X30	L	tumbled	M12	63	20	40	30
K0151.612X40	L	tumbled	M12	63	20	40	40
K0151.612X50	L	tumbled	M12	63	20	40	50



---

Order No.	style	Surface finish body	D	D1	D2	H	L
K0151.612X60	L	tumbled	M12	63	20	40	60