

Self-aligning pads, adjustable, with O-ring, exchangeable inserts, hexagon socket, style F, flattened ball with diamond grip

Item description/product images



Description

Material:

Body carbon steel
 Ball rust and acid resistant steel.
 Insert:
 style F tool steel.

Version:

Body tempered, black oxidized.
 Ball hardened, bright.
 Insert:
 style F hardened and black oxidized.

Note:

Self-aligning pads are used to support and clamp unmachined and machined workpieces.
 They can also be used as stops, supports and thrust pads in fixtures and toolmaking.
 The ball can be removed from the housing by applying light pressure to the socket head screw.

Ball secured against rotation.

Benefits:

Highly cost-effective as inserts can be exchanged.
 The built-in O-ring holds the ball in place and keeps dirt and foreign particles out, ensuring unistyle movement.

Drawings

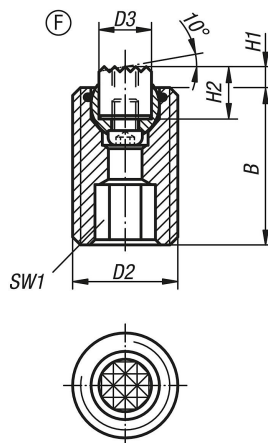

Order No.	style	B	D2	D3	H1	H2	SW1	Ball-Ø	Load rating max. kN (static load only)	Item No. gripper
K0291.320X030	F	30	M20	10	4	10	10	13	37	K0385.1010
K0291.320X050	F	50	M20	10	4	10	10	13	37	K0385.1010
K0291.320X070	F	70	M20	10	4	10	10	13	37	K0385.1010
K0291.324X040	F	40	M24	12	4	10	10	15	55	K0385.1210
K0291.324X080	F	80	M24	12	4	10	10	15	55	K0385.1210

**Self-aligning pads, adjustable, with O-ring, exchangeable inserts,
hexagon socket, style F, flattened ball with diamond grip**
