

Indexing plunger with cam lever, steel or stainless steel, style A, metric

Item description/product images

METRIC Parts

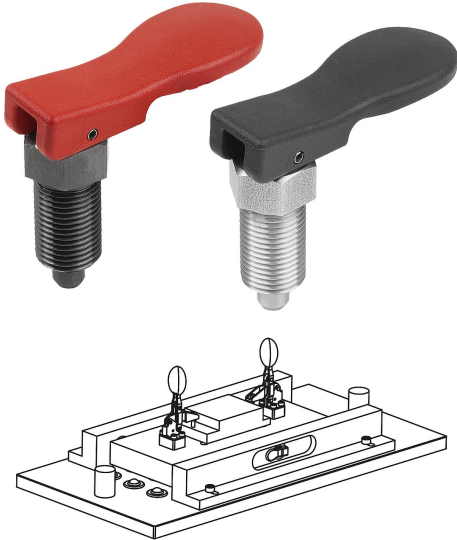

Description

Material:

Steel version:

Grub screw and indexing pin steel.

Stainless steel version:

Threaded body 1.4305 (AISI 303 equivalent)(AISI 303 equivalent).

Indexing pin 1.4305 (AISI 303 equivalent)(AISI 303 equivalent).

Handle fiberglass reinforced thermoplastic PPA (high temperature resistant).

Version:

Steel version:

threaded body, black oxidized.

Indexing pin hardened, ground and black oxidized.

Stainless steel version:

threaded body, bright.

Indexing pin ground and left bright.

Grip black or traffic red RAL3020.

Note:

Indexing plungers are used where it is necessary to prevent changes of position due to lateral forces. A new locking position can be set only after the plunger has been manually disengaged. With this indexing plunger a cam lever is used to retract the pin. The indexing plunger remains unlocked as long as the handle is positioned over the dead center of the cam.

The ergonomic cam lever enables light handling with low effort.

Temperature range:

Continuous operating temperature acc. to IEC 216 max. 160°C.

Temporary operating temperature max. 250°C.

Benefits:

Simple and quick operation.

Suitable for high temperature applications.

With integrated detent function.

On request:

Special versions.

Accessory:

Spacer rings K0665

Positioning bushings for indexing plunger K1290

Mounting Brackets, metric K0638

Indexing plunger with cam lever, steel or stainless steel, style A, metric

Drawings

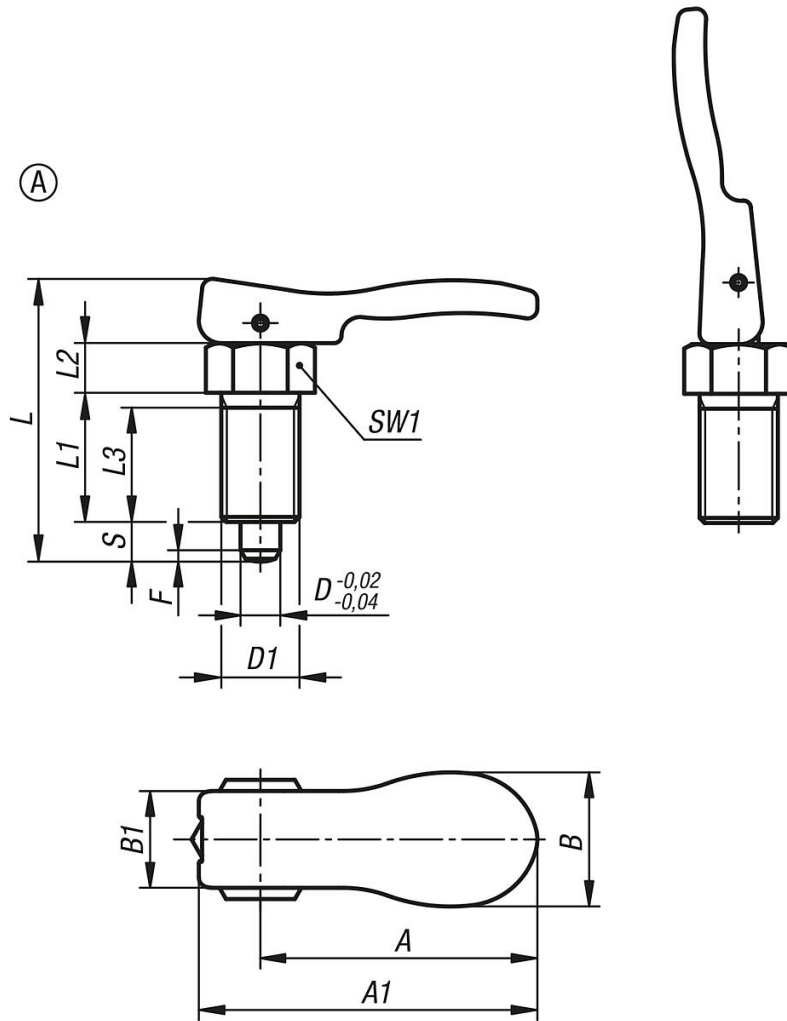

Order No.	Main material	Component color	style	A	A1	B	B1	D	D1	Travel S	L	L1	L2	L3	SW1	Fx30°	Spring force initial pressure F1 approx. N	Spring force final pressure F2 approx. N
K1584.8105	steel	black	A	31,7	41,7	17,9	12,9	5	M10x1	5	39	17	7	15	13	1,3	5	12
K1584.8206	steel	black	A	31,6	41,7	17,9	12,9	6	M12x1,5	6	44	20	8	17	14	1,8	6	14
K1584.8308	steel	black	A	55,5	67,8	26,9	19,4	8	M16x1,5	8	56,9	26	10	23	19	2,3	15	35
K1584.8410	steel	black	A	53,4	67,8	26,9	19,4	10	M20x1,5	10	62,9	28	12	25	22	2,8	15	34
K1584.8105154	steel	traffic red RAL 3020	A	31,7	41,7	17,9	12,9	5	M10x1	5	39	17	7	15	13	1,3	5	12
K1584.8206154	steel	traffic red RAL 3020	A	31,6	41,7	17,9	12,9	6	M12x1,5	6	44	20	8	17	14	1,8	6	14
K1584.8308154	steel	traffic red RAL 3020	A	55,5	67,8	26,9	19,4	8	M16x1,5	8	56,9	26	10	23	19	2,3	15	35
K1584.8410154	steel	traffic red RAL 3020	A	53,4	67,8	26,9	19,4	10	M20x1,5	10	62,9	28	12	25	22	2,8	15	34
K1584.18105	stainless steel	black	A	31,7	41,7	17,9	12,9	5	M10x1	5	39	17	7	15	13	1,3	5	12
K1584.18206	stainless steel	black	A	31,6	41,7	17,9	12,9	6	M12x1,5	6	44	20	8	17	14	1,8	6	14
K1584.18308	stainless steel	black	A	55,5	67,8	26,9	19,4	8	M16x1,5	8	56,9	26	10	23	19	2,3	15	35
K1584.18410	stainless steel	black	A	53,4	67,8	26,9	19,4	10	M20x1,5	10	62,9	28	12	25	22	2,8	15	34
K1584.18105154	stainless steel	traffic red RAL 3020	A	31,7	41,7	17,9	12,9	5	M10x1	5	39	17	7	15	13	1,3	5	12
K1584.18206154	stainless steel	traffic red RAL 3020	A	31,6	41,7	17,9	12,9	6	M12x1,5	6	44	20	8	17	14	1,8	6	14
K1584.18308154	stainless steel	traffic red RAL 3020	A	55,5	67,8	26,9	19,4	8	M16x1,5	8	56,9	26	10	23	19	2,3	15	35
K1584.18410154	stainless steel	traffic red RAL 3020	A	53,4	67,8	26,9	19,4	10	M20x1,5	10	62,9	28	12	25	22	2,8	15	34

