

Indexing plungers with collar for Hygienic USIT® seal and shim washers, style A, without locking slot

Item description/product images

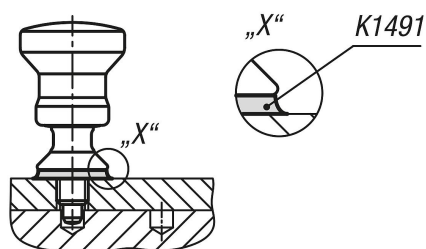
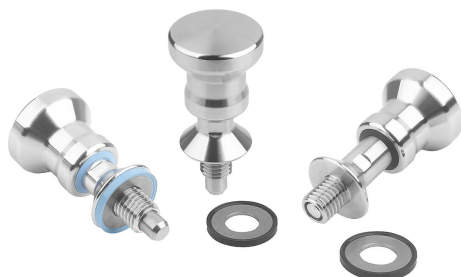

Description

Product description:

Indexing plungers are used where it is necessary to prevent changes of position due to lateral forces. A new locking position can be set only after the plunger has been manually retracted. Style C (with lockout slot) is recommended for applications where the indexing pin should remain disengaged for an extended period and be prevented from springing back.

This indexing plunger is suitable for the foodstuff sectors. It has a conical collar so that the fastening point can be hygienically sealed using the Hygienic USIT® sealing and shim washer. The surface finish is $Ra < 0.8 \mu m$, which prevents dirt particles from adhering and ensures easy cleaning.

Material:

Steel parts stainless steel 1.4404 (AISI 316L equivalent).

Seal 70 EPDM 295 (black) or 75 Fluoroprene® XP (blue).

Version:

Indexing pin hardened or not hardened, bright.

Temperature range:

70 EPDM 295: -40 °C to 150 °C.

75 Fluoroprene® XP: -15 °C to 200 °C.

Benefits:

Hygienic conform design

Stainless steel 1.4404

Suitable for CIP/SIP cleaning

Resistant to polar and nonpolar media as well as aromatic substances

Certified according to DGUV test

Supplied with:

Indexing plunger including seal and shim washer Hygienic USIT®.

Accessory:

Hygienic USIT® seal and shim washers K1491.

Indexing plungers with collar for Hygienic USIT® seal and shim washers, style A, without locking slot

Drawings

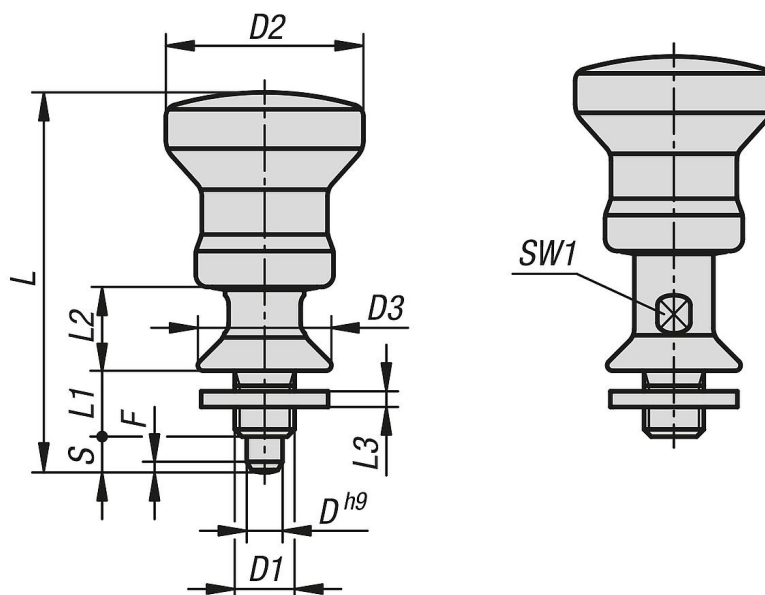

Order No.	style	Main material	locating pin	Component color	D	D1	D2	D3	L	L1	L2	L3	Travel S	SW1	Fx30°	Spring force initial pressure F1 approx. N	Spring force final pressure F2 approx. N
K1698.0110601	A	stainless steel	hardened	black	6	M10	33	22,3	63,5	11	14	1,5	6	12	1,8	40	45
K1698.0110611	A	stainless steel	hardened	black	6	M10x1	33	22,3	63,5	11	14	1,5	6	12	1,8	40	45
K1698.0120801	A	stainless steel	hardened	black	8	M12	33	26,6	69,5	13	16	1,5	8	12	2,3	40	62
K1698.0120811	A	stainless steel	hardened	black	8	M12x1,5	33	26,6	69,5	13	16	1,5	8	12	2,3	40	62
K1698.0110602	A	stainless steel	hardened	blue	6	M10	33	22,3	63,5	11	14	1,5	6	12	1,8	40	45
K1698.0110612	A	stainless steel	hardened	blue	6	M10x1	33	22,3	63,5	11	14	1,5	6	12	1,8	40	45
K1698.0120802	A	stainless steel	hardened	blue	8	M12	33	26,6	69,5	13	16	1,5	8	12	2,3	40	62
K1698.0120812	A	stainless steel	hardened	blue	8	M12x1,5	33	26,6	69,5	13	16	1,5	8	12	2,3	40	62
K1698.1110601	A	stainless steel	not hardened	black	6	M10	33	22,3	63,5	11	14	1,5	6	12	1,8	40	45
K1698.1110611	A	stainless steel	not hardened	black	6	M10x1	33	22,3	63,5	11	14	1,5	6	12	1,8	40	45
K1698.1120801	A	stainless steel	not hardened	black	8	M12	33	26,6	69,5	13	16	1,5	8	12	2,3	40	62
K1698.1120811	A	stainless steel	not hardened	black	8	M12x1,5	33	26,6	69,5	13	16	1,5	8	12	2,3	40	62
K1698.1110602	A	stainless steel	not hardened	blue	6	M10	33	22,3	63,5	11	14	1,5	6	12	1,8	40	45
K1698.1110612	A	stainless steel	not hardened	blue	6	M10x1	33	22,3	63,5	11	14	1,5	6	12	1,8	40	45
K1698.1120802	A	stainless steel	not hardened	blue	8	M12	33	26,6	69,5	13	16	1,5	8	12	2,3	40	62
K1698.1120812	A	stainless steel	not hardened	blue	8	M12x1,5	33	26,6	69,5	13	16	1,5	8	12	2,3	40	62