

Shoulder screws similar to ISO 7379

Item description/product images



Description

Material:

Steel or stainless steel A2.

Version:

Grade 12.9. Shaft OD ground and bright.

Bright stainless steel or tempered steel.

Note:

Hexagon socket head shoulder screws are precision construction elements for many applications. As they can simplify complicated constructions, they are frequently chosen as the most cost-effective solution. Shoulder screws provide the decisive rationalising effect required today.

Drawings

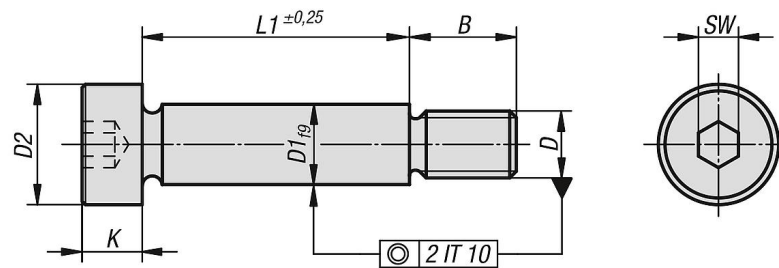

Shoulder screws similar to ISO 7379

Order No.	Main material	D1	D	D2	B	K	SW	L1
K0705.04X06	steel	4	M3	7	7	3	2	6
K0705.04X08	steel	4	M3	7	7	3	2	8
K0705.04X10	steel	4	M3	7	7	3	2	10
K0705.04X12	steel	4	M3	7	7	3	2	12
K0705.04X16	steel	4	M3	7	7	3	2	16
K0705.04X20	steel	4	M3	7	7	3	2	20
K0705.04X04	steel	4	M3	7	7	3	2	4
K0705.04X05	steel	4	M3	7	7	3	2	5
K0705.04X25	steel	4	M3	7	7	3	2	25
K0705.04X30	steel	4	M3	7	7	3	2	30
K0705.05X16	steel	5	M4	9	8	4	2,5	16
K0705.05X20	steel	5	M4	9	8	4	2,5	20
K0705.05X08	steel	5	M4	9	8	4	2,5	8
K0705.05X10	steel	5	M4	9	8	4	2,5	10
K0705.05X30	steel	5	M4	9	8	4	2,5	30
K0705.05X40	steel	5	M4	9	8	4	2,5	40
K0705.05X05	steel	5	M4	9	8	4	2,5	5
K0705.05X06	steel	5	M4	9	8	4	2,5	6
K0705.05X12	steel	5	M4	9	8	4	2,5	12
K0705.05X25	steel	5	M4	9	8	4	2,5	25
K0705.06X10	steel	6	M5	10	9,5	4,5	3	10
K0705.06X16	steel	6	M5	10	9,5	4,5	3	16
K0705.06X20	steel	6	M5	10	9,5	4,5	3	20
K0705.06X25	steel	6	M5	10	9,5	4,5	3	25

Shoulder screws similar to ISO 7379

Order No.	Main material	D1	D	D2	B	K	SW	L1
K0705.06X30	steel	6	M5	10	9,5	4,5	3	30
K0705.06X40	steel	6	M5	10	9,5	4,5	3	40
K0705.06X50	steel	6	M5	10	9,5	4,5	3	50
K0705.06X60	steel	6	M5	10	9,5	4,5	3	60
K0705.06X70	steel	6	M5	10	9,5	4,5	3	70
K0705.06X12	steel	6	M5	10	9,5	4,5	3	12
K0705.06X35	steel	6	M5	10	9,5	4,5	3	35
K0705.06X45	steel	6	M5	10	9,5	4,5	3	45
K0705.06X55	steel	6	M5	10	9,5	4,5	3	55
K0705.06X65	steel	6	M5	10	9,5	4,5	3	65
K0705.06X80	steel	6	M5	10	9,5	4,5	3	80
K0705.08X16	steel	8	M6	13	11	5,5	4	16
K0705.08X20	steel	8	M6	13	11	5,5	4	20
K0705.08X25	steel	8	M6	13	11	5,5	4	25
K0705.08X30	steel	8	M6	13	11	5,5	4	30
K0705.08X40	steel	8	M6	13	11	5,5	4	40
K0705.08X50	steel	8	M6	13	11	5,5	4	50
K0705.08X60	steel	8	M6	13	11	5,5	4	60
K0705.08X70	steel	8	M6	13	11	5,5	4	70
K0705.08X90	steel	8	M6	13	11	5,5	4	90
K0705.08X45	steel	8	M6	13	11	5,5	4	45
K0705.08X55	steel	8	M6	13	11	5,5	4	55
K0705.08X65	steel	8	M6	13	11	5,5	4	65
K0705.08X80	steel	8	M6	13	11	5,5	4	80
K0705.08X100	steel	8	M6	13	11	5,5	4	100
K0705.10X16	steel	10	M8	16	13	7	5	16
K0705.10X20	steel	10	M8	16	13	7	5	20
K0705.10X25	steel	10	M8	16	13	7	5	25
K0705.10X30	steel	10	M8	16	13	7	5	30
K0705.10X40	steel	10	M8	16	13	7	5	40
K0705.10X50	steel	10	M8	16	13	7	5	50
K0705.10X60	steel	10	M8	16	13	7	5	60
K0705.10X70	steel	10	M8	16	13	7	5	70
K0705.10X80	steel	10	M8	16	13	7	5	80
K0705.10X45	steel	10	M8	16	13	7	5	45
K0705.10X90	steel	10	M8	16	13	7	5	90
K0705.10X35	steel	10	M8	16	13	7	5	35
K0705.10X55	steel	10	M8	16	13	7	5	55
K0705.10X65	steel	10	M8	16	13	7	5	65
K0705.10X100	steel	10	M8	16	13	7	5	100
K0705.12X100	steel	12	M10	18	16	9	6	100
K0705.12X16	steel	12	M10	18	16	9	6	16
K0705.12X20	steel	12	M10	18	16	9	6	20
K0705.12X25	steel	12	M10	18	16	9	6	25
K0705.12X30	steel	12	M10	18	16	9	6	30
K0705.12X40	steel	12	M10	18	16	9	6	40
K0705.12X50	steel	12	M10	18	16	9	6	50
K0705.12X60	steel	12	M10	18	16	9	6	60
K0705.12X70	steel	12	M10	18	16	9	6	70
K0705.12X80	steel	12	M10	18	16	9	6	80
K0705.12X90	steel	12	M10	18	16	9	6	90
K0705.12X65	steel	12	M10	18	16	8	6	65
K0705.12X55	steel	12	M10	18	16	8	6	55
K0705.12X35	steel	12	M10	18	16	8	6	35
K0705.12X45	steel	12	M10	18	16	8	6	45
K0705.16X100	steel	16	M12	24	18	11	8	100
K0705.16X120	steel	16	M12	24	18	11	8	120
K0705.16X25	steel	16	M12	24	18	11	8	25
K0705.16X30	steel	16	M12	24	18	11	8	30
K0705.16X40	steel	16	M12	24	18	11	8	40
K0705.16X50	steel	16	M12	24	18	11	8	50
K0705.16X55	steel	16	M12	24	18	11	8	55
K0705.16X60	steel	16	M12	24	18	11	8	60

Shoulder screws similar to ISO 7379

Order No.	Main material	D1	D	D2	B	K	SW	L1
K0705.16X65	steel	16	M12	24	18	11	8	65
K0705.16X70	steel	16	M12	24	18	11	8	70
K0705.16X80	steel	16	M12	24	18	11	8	80
K0705.16X90	steel	16	M12	24	18	11	8	90
K0705.16X45	steel	16	M12	24	18	11	8	45
K0705.16X35	steel	16	M12	24	18	11	8	35
K0705.20X100	steel	20	M16	30	22	14	10	100
K0705.20X120	steel	20	M16	30	22	14	10	120
K0705.20X50	steel	20	M16	30	22	14	10	50
K0705.20X60	steel	20	M16	30	22	14	10	60
K0705.20X70	steel	20	M16	30	22	14	10	70
K0705.20X80	steel	20	M16	30	22	14	10	80
K0705.20X90	steel	20	M16	30	22	14	10	90
K0705.20X35	steel	20	M16	30	22	14	10	35
K0705.20X30	steel	20	M16	30	22	14	10	30
K0705.20X40	steel	20	M16	30	22	14	10	40
K0705.20X45	steel	20	M16	30	22	14	10	45
K0705.20X55	steel	20	M16	30	22	14	10	55
K0705.20X65	steel	20	M16	30	22	14	10	65
K0705.24X60	steel	24	M20	36	27	16	12	60
K0705.24X70	steel	24	M20	36	27	16	12	70
K0705.24X65	steel	24	M20	36	27	16	12	65
K0705.24X50	steel	24	M20	36	27	16	12	50
K0705.24X55	steel	24	M20	36	27	16	12	55
K0705.24X80	steel	24	M20	36	27	16	12	80
K0705.24X90	steel	24	M20	36	27	16	12	90
K0705.24X100	steel	24	M20	36	27	16	12	100
K0705.104X06	stainless steel A2	4	M3	7	7	3	2	6
K0705.104X08	stainless steel A2	4	M3	7	7	3	2	8
K0705.104X10	stainless steel A2	4	M3	7	7	3	2	10
K0705.104X16	stainless steel A2	4	M3	7	7	3	2	16
K0705.104X20	stainless steel A2	4	M3	7	7	3	2	20
K0705.104X04	stainless steel A2	4	M3	7	7	3	2	4
K0705.104X05	stainless steel A2	4	M3	7	7	3	2	5
K0705.104X12	stainless steel A2	4	M3	7	7	3	2	12
K0705.105X08	stainless steel A2	5	M4	9	8	4	2,5	8
K0705.105X10	stainless steel A2	5	M4	9	8	4	2,5	10
K0705.105X16	stainless steel A2	5	M4	9	8	4	2,5	16
K0705.105X20	stainless steel A2	5	M4	9	8	4	2,5	20
K0705.105X30	stainless steel A2	5	M4	9	8	4	2,5	30
K0705.105X40	stainless steel A2	5	M4	9	8	4	2,5	40
K0705.105X05	stainless steel A2	5	M4	9	8	4	2,5	5
K0705.105X06	stainless steel A2	5	M4	9	8	4	2,5	6
K0705.105X12	stainless steel A2	5	M4	9	8	4	2,5	12
K0705.105X25	stainless steel A2	5	M4	9	8	4	2,5	25
K0705.106X16	stainless steel A2	6	M5	10	9,5	4,5	3	16
K0705.106X20	stainless steel A2	6	M5	10	9,5	4,5	3	20
K0705.106X25	stainless steel A2	6	M5	10	9,5	4,5	3	25
K0705.106X30	stainless steel A2	6	M5	10	9,5	4,5	3	30
K0705.106X40	stainless steel A2	6	M5	10	9,5	4,5	3	40
K0705.106X50	stainless steel A2	6	M5	10	9,5	4,5	3	50
K0705.106X60	stainless steel A2	6	M5	10	9,5	4,5	3	60
K0705.106X10	stainless steel A2	6	M5	10	9,5	4,5	3	10
K0705.106X12	stainless steel A2	6	M5	10	9,5	4,5	3	12
K0705.108X16	stainless steel A2	8	M6	13	11	5,5	4	16
K0705.108X20	stainless steel A2	8	M6	13	11	5,5	4	20
K0705.108X25	stainless steel A2	8	M6	13	11	5,5	4	25
K0705.108X30	stainless steel A2	8	M6	13	11	5,5	4	30
K0705.108X40	stainless steel A2	8	M6	13	11	5,5	4	40
K0705.108X50	stainless steel A2	8	M6	13	11	5,5	4	50
K0705.108X60	stainless steel A2	8	M6	13	11	5,5	4	60
K0705.110X16	stainless steel A2	10	M8	16	13	7	5	16
K0705.110X20	stainless steel A2	10	M8	16	13	7	5	20

Shoulder screws similar to ISO 7379

Order No.	Main material	D1	D	D2	B	K	SW	L1
K0705.110X25	stainless steel A2	10	M8	16	13	7	5	25
K0705.110X30	stainless steel A2	10	M8	16	13	7	5	30
K0705.110X40	stainless steel A2	10	M8	16	13	7	5	40
K0705.110X50	stainless steel A2	10	M8	16	13	7	5	50
K0705.110X60	stainless steel A2	10	M8	16	13	7	5	60
K0705.110X70	stainless steel A2	10	M8	16	13	7	5	70
K0705.110X80	stainless steel A2	10	M8	16	13	7	5	80
K0705.110X90	stainless steel A2	10	M8	16	13	7	5	90
K0705.110X100	stainless steel A2	10	M8	16	13	7	5	100
K0705.112X16	stainless steel A2	12	M10	18	16	9	6	16
K0705.112X20	stainless steel A2	12	M10	18	16	9	6	20
K0705.112X25	stainless steel A2	12	M10	18	16	9	6	25
K0705.112X30	stainless steel A2	12	M10	18	16	9	6	30
K0705.112X40	stainless steel A2	12	M10	18	16	9	6	40
K0705.112X50	stainless steel A2	12	M10	18	16	9	6	50
K0705.112X60	stainless steel A2	12	M10	18	16	9	6	60
K0705.112X70	stainless steel A2	12	M10	18	16	9	6	70
K0705.112X80	stainless steel A2	12	M10	18	16	9	6	80
K0705.112X90	stainless steel A2	12	M10	18	16	9	6	90
K0705.112X100	stainless steel A2	12	M10	18	16	9	6	100
K0705.116X30	stainless steel A2	16	M12	24	18	11	8	30
K0705.116X40	stainless steel A2	16	M12	24	18	11	8	40
K0705.116X50	stainless steel A2	16	M12	24	18	11	8	50
K0705.116X60	stainless steel A2	16	M12	24	18	11	8	60
K0705.116X70	stainless steel A2	16	M12	24	18	11	8	70
K0705.116X80	stainless steel A2	16	M12	24	18	11	8	80
K0705.116X90	stainless steel A2	16	M12	24	18	11	8	90
K0705.116X100	stainless steel A2	16	M12	24	18	11	8	100
K0705.116X120	stainless steel A2	16	M12	24	18	11	8	120
K0705.120X30	stainless steel A2	20	M16	30	22	14	10	30
K0705.120X40	stainless steel A2	20	M16	30	22	14	10	40
K0705.120X50	stainless steel A2	20	M16	30	22	14	10	50
K0705.120X60	stainless steel A2	20	M16	30	22	14	10	60
K0705.120X70	stainless steel A2	20	M16	30	22	14	10	70
K0705.120X80	stainless steel A2	20	M16	30	22	14	10	80
K0705.120X90	stainless steel A2	20	M16	30	22	14	10	90
K0705.120X100	stainless steel A2	20	M16	30	22	14	10	100
K0705.120X120	stainless steel A2	20	M16	30	22	14	10	120