

# Cam levers, stainless steel with external thread, plastic thrust washer and stainless steel stud - inch

Item description/product images

INCH  
Parts



## Description

### Material:

Handles 1.4308 (AISI "316" equivalent) stainless steel.

Thrust washer plastic PA 66 GF 35-X, fiberglass reinforced.

Hinge pin, washer and screw 1.4305 (AISI 303 equivalent) stainless steel.

### Version:

Handle electropolished or blasted.

Thrust washer black.

Hinge pin, washer and screw bright.

### Note:

Plastics are subject to creeping under load (retardation).

## Drawings

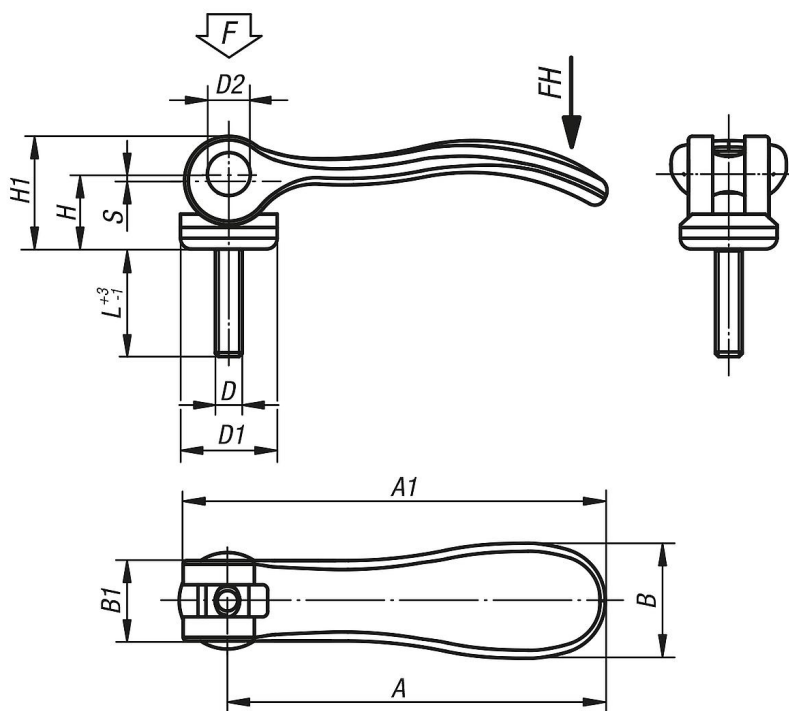

| Order No.        | Surface finish body | D    | D1   | D2 | B    | B1   | H    | H1 | A    | A1   | L  | Travel S | Clamping force F (kN) | Hand force FH N |
|------------------|---------------------|------|------|----|------|------|------|----|------|------|----|----------|-----------------------|-----------------|
| K0645.95120ADX10 | electropolished     | 6-32 | 12   | 6  | 14,4 | 11,5 | 9    | 13 | 36,2 | 41,7 | 10 | 1        | 1,5                   | 90              |
| K0645.95120ADX15 | electropolished     | 6-32 | 12   | 6  | 14,4 | 11,5 | 9    | 13 | 36,2 | 41,7 | 15 | 1        | 1,5                   | 90              |
| K0645.95120ADX30 | electropolished     | 6-32 | 12   | 6  | 14,4 | 11,5 | 9    | 13 | 36,2 | 41,7 | 30 | 1        | 1,5                   | 90              |
| K0645.95120AEX10 | electropolished     | 8-32 | 12   | 6  | 14,4 | 11,5 | 9    | 13 | 36,2 | 41,7 | 10 | 1        | 1,5                   | 90              |
| K0645.95120AEX15 | electropolished     | 8-32 | 12   | 6  | 14,4 | 11,5 | 9    | 13 | 36,2 | 41,7 | 15 | 1        | 1,5                   | 90              |
| K0645.95120AEX30 | electropolished     | 8-32 | 12   | 6  | 14,4 | 11,5 | 9    | 13 | 36,2 | 41,7 | 30 | 1        | 1,5                   | 90              |
| K0645.05120AEX15 | electropolished     | 8-32 | 15,4 | 8  | 18   | 13   | 11,2 | 17 | 52,3 | 59,1 | 15 | 1        | 2,5                   | 100             |

## Cam levers, stainless steel with external thread, plastic thrust washer and stainless steel stud - inch

| Order No.        | Surface finish body | D       | D1   | D2 | B    | B1 | H    | H1   | A    | A1   | L  | Travel S | Clamping force F (kN) | Hand force FH N |
|------------------|---------------------|---------|------|----|------|----|------|------|------|------|----|----------|-----------------------|-----------------|
| K0645.05120AEX20 | electropolished     | 8-32    | 15,4 | 8  | 18   | 13 | 11,2 | 17   | 52,3 | 59,1 | 20 | 1        | 2,5                   | 100             |
| K0645.05120AEX30 | electropolished     | 8-32    | 15,4 | 8  | 18   | 13 | 11,2 | 17   | 52,3 | 59,1 | 30 | 1        | 2,5                   | 100             |
| K0645.05120A0X20 | electropolished     | 10-24   | 15,4 | 8  | 18   | 13 | 11,2 | 17   | 52,3 | 59,1 | 20 | 1        | 2,5                   | 100             |
| K0645.05120A0X30 | electropolished     | 10-24   | 15,4 | 8  | 18   | 13 | 11,2 | 17   | 52,3 | 59,1 | 30 | 1        | 2,5                   | 100             |
| K0645.05120A0X40 | electropolished     | 10-24   | 15,4 | 8  | 18   | 13 | 11,2 | 17   | 52,3 | 59,1 | 40 | 1        | 2,5                   | 100             |
| K0645.05120A0X50 | electropolished     | 10-24   | 15,4 | 8  | 18   | 13 | 11,2 | 17   | 52,3 | 59,1 | 50 | 1        | 2,5                   | 100             |
| K0645.05120A1X20 | electropolished     | 10-32   | 15,4 | 8  | 18   | 13 | 11,2 | 17   | 52,3 | 59,1 | 20 | 1        | 2,5                   | 100             |
| K0645.05120A1X30 | electropolished     | 10-32   | 15,4 | 8  | 18   | 13 | 11,2 | 17   | 52,3 | 59,1 | 30 | 1        | 2,5                   | 100             |
| K0645.05120A1X40 | electropolished     | 10-32   | 15,4 | 8  | 18   | 13 | 11,2 | 17   | 52,3 | 59,1 | 40 | 1        | 2,5                   | 100             |
| K0645.05120A1X50 | electropolished     | 10-32   | 15,4 | 8  | 18   | 13 | 11,2 | 17   | 52,3 | 59,1 | 50 | 1        | 2,5                   | 100             |
| K0645.15120A1X20 | electropolished     | 10-32   | 18,1 | 9  | 21,5 | 15 | 14,5 | 22   | 70,4 | 79,2 | 20 | 1,2      | 4                     | 120             |
| K0645.15120A1X30 | electropolished     | 10-32   | 18,1 | 9  | 21,5 | 15 | 14,5 | 22   | 70,4 | 79,2 | 30 | 1,2      | 4                     | 120             |
| K0645.15120A1X40 | electropolished     | 10-32   | 18,1 | 9  | 21,5 | 15 | 14,5 | 22   | 70,4 | 79,2 | 40 | 1,2      | 4                     | 120             |
| K0645.15120A1X50 | electropolished     | 10-32   | 18,1 | 9  | 21,5 | 15 | 14,5 | 22   | 70,4 | 79,2 | 50 | 1,2      | 4                     | 120             |
| K0645.15120A2X20 | electropolished     | 1/4-20  | 18,1 | 9  | 21,5 | 15 | 14,5 | 22   | 70,4 | 79,2 | 20 | 1,2      | 4                     | 120             |
| K0645.15120A2X30 | electropolished     | 1/4-20  | 18,1 | 9  | 21,5 | 15 | 14,5 | 22   | 70,4 | 79,2 | 30 | 1,2      | 4                     | 120             |
| K0645.15120A2X40 | electropolished     | 1/4-20  | 18,1 | 9  | 21,5 | 15 | 14,5 | 22   | 70,4 | 79,2 | 40 | 1,2      | 4                     | 120             |
| K0645.15120A2X50 | electropolished     | 1/4-20  | 18,1 | 9  | 21,5 | 15 | 14,5 | 22   | 70,4 | 79,2 | 50 | 1,2      | 4                     | 120             |
| K0645.25120A3X25 | electropolished     | 5/16-18 | 27,1 | 11 | 33,3 | 24 | 18   | 28,5 | 96   | 108  | 25 | 1,5      | 8                     | 350             |
| K0645.25120A3X30 | electropolished     | 5/16-18 | 27,1 | 11 | 33,3 | 24 | 18   | 28,5 | 96   | 108  | 30 | 1,5      | 8                     | 350             |
| K0645.25120A3X40 | electropolished     | 5/16-18 | 27,1 | 11 | 33,3 | 24 | 18   | 28,5 | 96   | 108  | 40 | 1,5      | 8                     | 350             |
| K0645.25120A3X50 | electropolished     | 5/16-18 | 27,1 | 11 | 33,3 | 24 | 18   | 28,5 | 96   | 108  | 50 | 1,5      | 8                     | 350             |
| K0645.25120A4X25 | electropolished     | 3/8-16  | 27,1 | 11 | 33,3 | 24 | 18   | 28,5 | 96   | 108  | 25 | 1,5      | 8                     | 350             |
| K0645.25120A4X30 | electropolished     | 3/8-16  | 27,1 | 11 | 33,3 | 24 | 18   | 28,5 | 96   | 108  | 30 | 1,5      | 8                     | 350             |
| K0645.25120A4X40 | electropolished     | 3/8-16  | 27,1 | 11 | 33,3 | 24 | 18   | 28,5 | 96   | 108  | 40 | 1,5      | 8                     | 350             |
| K0645.25120A4X50 | electropolished     | 3/8-16  | 27,1 | 11 | 33,3 | 24 | 18   | 28,5 | 96   | 108  | 50 | 1,5      | 8                     | 350             |